

### Solid Copper Earth Rods

These earth rods are designed for use where extremely high corrosion resistance and exceptionally long life are required. Solid copper earth rods are produced from solid copper bar and are internally threaded for jointing. When deep driving a solid copper earth rod the usual practice is to insert the rod into a bore hole and backfill with either Low-Resistance Earthing Compound or Bentonite, (see page 44 for further details).

Shank D mm	L mm	Thread Size	L1 mm	Unit Weight kg	Pack Quantity	Part Number
15	1200	M10	20	1.88	5	ERC 112
16	1500	M10	20	2.66	5	ERC 115
	1800			3.20		ERC 118
	2400			4.28		ERC 124
	3000			5.36		ERC 130
20	1200	M10	20	3.34	5	ERC 212
	1500			4.18		ERC 215
	1800			5.03		ERC 218
	2400			6.71		ERC 224
	2500			7.00		ERC 225
	3000			8.40		ERC 230
25	1000	M12	25	4.37	1	ERC 310
	1200			5.25		ERC 312
	1500			6.54		ERC 315
	1800			7.86		ERC 318
	2000			8.73		ERC 320
	2400			10.50		ERC 324
	2500			10.90		ERC 325
	3000			13.10		ERC 330
	3600			15.90		ERC 336

Material: Copper to BS EN 13601.



BS EN 62561-2

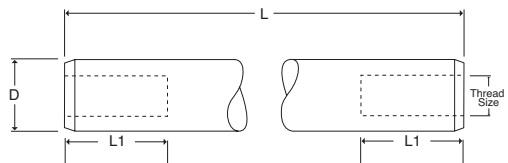

### Driving Heads

The driving head protects the internal thread and the top of the solid copper earth rod from damage when being driven into the ground.

D mm	L mm	Thread Size	L1 mm	Unit Weight kg	Pack Quantity	Part Number
16	38	M10	20	0.03	25	ERCD 16
20	41	M10	20	0.06		ERCD 20
25	45	M12	25	0.10		ERCD 25

Material: Steel.

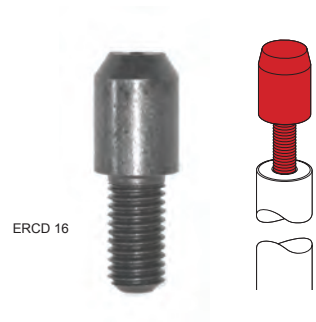
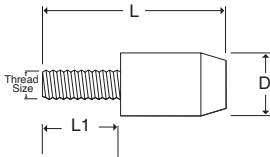

ERCD 16

### Driving Spikes

These driving spikes enable solid copper earth rods to be driven easily into the ground.

D mm	L mm	Thread Size	L1 mm	Unit Weight kg	Pack Quantity	Part Number
16	42	M10	20	0.03	25	ERCS 16
20	51	M10	20	0.06		ERCS 20
25	60	M12	25	0.10		ERCS 25

Material: Steel.

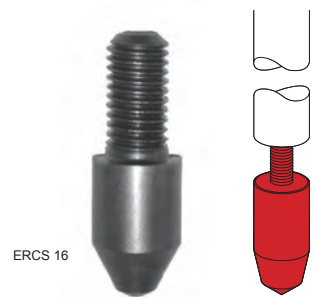
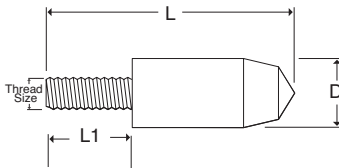

ERCS 16

### Coupling Dowels

The phosphor bronze coupling dowel is used for joining solid copper earth rods together.

Thread Size	L mm	Unit Weight kg	Pack Quantity	Part Number
M10	40	0.02	25	ERD 01
M12	50	0.04		ERD 02

Material: Phosphor Bronze.



BS EN 62561-1 Class H

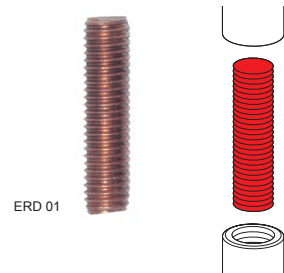
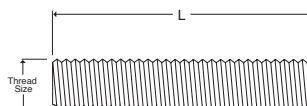

ERD 01