

Flexible Copper Braid Bonds

These flexible copper braid bonds are used for bonding metal gates, doors, fences etc. Other lengths and sizes are available on request.

Size W x H mm	Hole Centres L mm	Hole Size mm	Unit Weight kg	Pack Quantity	Part Number
10 x 2	100	6	0.01	10	BFE 1021
	200		0.01		BFE 1022
	300		0.01		BFE 1023
12 x 2	100	6	0.01		BFE 121
	200		0.01		BFE 122
	300		0.02		BFE 123
19 x 2.5	100	10	0.01		BFE 191
	200		0.03		BFE 192
	300		0.05		BFE 193
25 x 3	100	10	0.02		BFE 2531
	200		0.05		BFE 2532
	400		0.10		BFE 2534
25 x 3.5	200	11	0.09	BFE 200	
	300		0.13	BFE 300	
	400		0.16	BFE 400	
30 x 4.5	200	10	0.10	BFE 302	
	400		0.20	BFE 304	
32 x 5	200	10	0.14	BFE 322	
	400		0.28	BFE 324	

Material: Copper.



BS EN 62561-1 Class H



Tightening torque 20 Nm

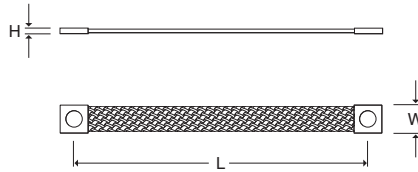
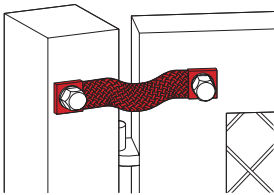

Tinned Flexible Copper Braid Bonds

These flexible copper braid bonds are used for bonding metal gates, doors, fences etc. Other lengths and sizes are available on request.

Size W x H mm	Hole Centres L mm	Hole Size mm	Unit Weight kg	Pack Quantity	Part Number	
10 x 2	100	6	0.01	10	BFE 1021T	
	200		0.01		BFE 1022T	
	300		0.01		BFE 1023T	
12 x 2	100		0.01		BFE 121T	
	200		0.01		BFE 122T	
	300		0.02		BFE 123T	
19 x 2.5	100		10		0.01	BFE 191T
	200				0.03	BFE 192T
	300				0.05	BFE 193T
25 x 3	100	0.02			BFE 2531T	
	200	0.05			BFE 2532T	
	400	0.10			BFE 2534T	
25 x 3.5	200	11			0.09	BFE 200T
	300				0.13	BFE 300T
	400				0.16	BFE 400T
30 x 4.5	200		10		0.10	BFE 302T
	400				0.20	BFE 304T
32 x 5	200				0.14	BFE 322T
	400	0.28			BFE 324T	

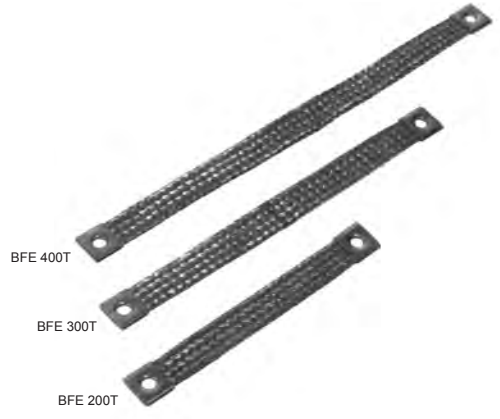

Material: Tinned Copper.

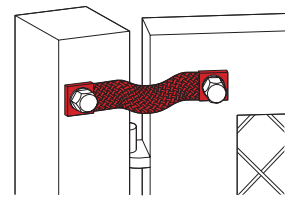
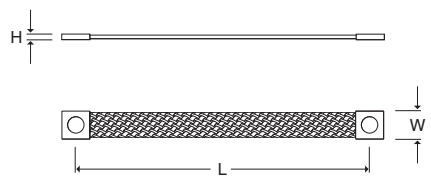



Flexible Circular Copper Braid Bonds

These flexible circular copper braid bonds are used for bonding metal gates, doors, fences etc. Other lengths and sizes are available on request.

Nominal Area mm ²	Hole Centres L mm	Hole Size mm	Unit Weight kg	Pack Quantity	Part Number
4	100	M6	0.01	10	BCE 410
	200		0.01		BCE 420
	300		0.01		BCE 430
6	100		0.01		BCE 610
	200		0.01		BCE 620
	300		0.02		BCE 630
10	100		0.01		BCE 101
	200		0.02		BCE 102
	300		0.03		BCE 103
16	100		0.01		BCE 1616
	200		0.03		BCE 1626
	300		0.05		BCE 1636
	100	0.01	BCE 161		
	200	0.03	BCE 162		
	300	0.05	BCE 163		
25	200	0.03	BCE 252		
	400	0.05	BCE 254		
35	200	M10	0.07	BCE 352	
	400		0.14	BCE 354	
50	200		0.10	BCE 502	
	400		0.20	BCE 504	
70	200		0.14	BCE 702	
	400		0.28	BCE 704	

Material: Copper.

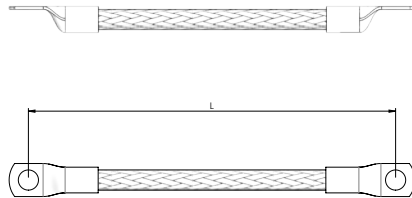
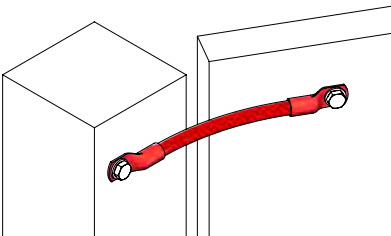

Tinned Flexible Circular Copper Braid Bonds

These tinned flexible copper braid bonds are used for bonding metal gates, doors, fences etc. Other lengths and sizes are available on request.

Nominal Area mm ²	Hole Centres L mm	Hole Size mm	Unit Weight kg	Pack Quantity	Part Number
4	100	M6	0.01	10	BCE 410T
	200		0.01		BCE 420T
	300		0.01		BCE 430T
6	100		0.01		BCE 610T
	200		0.01		BCE 620T
	300		0.02		BCE 630T
10	100		0.01		BCE 101T
	200		0.02		BCE 102T
	300		0.03		BCE 103T
16	100		0.01		BCE 1616T
	200		0.03		BCE 1626T
	300		0.05		BCE 1636T
	100	0.01	BCE 161T		
	200	0.03	BCE 162T		
	300	0.05	BCE 163T		
25	200	0.03	BCE 252T		
	400	0.05	BCE 254T		
35	200	0.07	BCE 352T		
	400	0.14	BCE 354T		
50	200	0.10	BCE 502T		
	400	0.20	BCE 504T		
70	200	0.14	BCE 702T		
	400	0.28	BCE 704T		

Material: Tinned Copper.

