

30

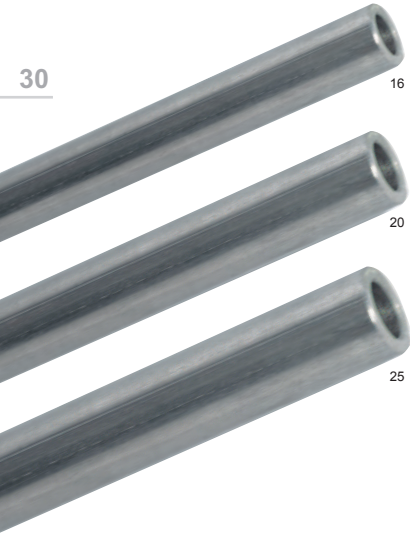

Stainless Steel Earth Rods

These earth rods are designed for use where problems may be caused by galvanic corrosion due to dissimilar metals being buried in close proximity. They are produced from stainless steel rod and are internally threaded for joining. They are highly resistant to corrosion.

Shank D mm	L mm	Thread Size	L1 mm	Unit Weight kg	Pack Quantity	Part Number
16	1200	M10	20	1.87	5	ERZ 112
	1500			2.35		ERZ 115
	1800			2.83		ERZ 118
	2400			3.74		ERZ 124
	3000			4.75		ERZ 130
20	1200	M10	20	2.95	5	ERZ 212
	1500			3.79		ERZ 215
	1800			4.46		ERZ 218
	2400			6.10		ERZ 224
	3000			7.57		ERZ 230
25	1200	M12	25	4.64	1	ERZ 312
	1500			5.81		ERZ 315
	1800			6.99		ERZ 318
	2400			9.34		ERZ 324
	3000			11.69		ERZ 330

Material: Stainless Steel to BS EN 10088.



BS EN 62561-2

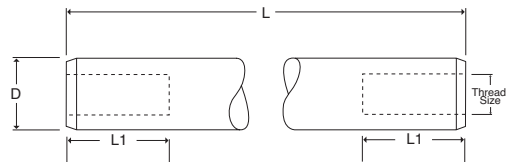
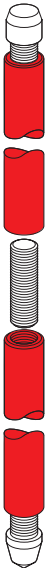

Driving Heads

The driving head protects the internal thread and the top of the stainless steel earth rod from damage when being driven into the ground.

D mm	L mm	Thread Size	L1 mm	Unit Weight kg	Pack Quantity	Part Number
16	38	M10	20	0.03	25	ERCD 16
20	41	M10	20	0.06		ERCD 20
25	45	M12	25	0.10		ERCD 25

Material: Steel.

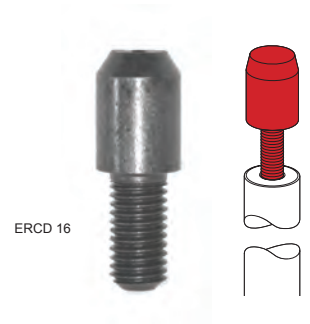
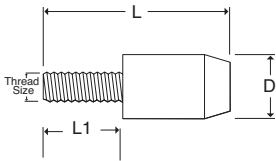

ERCD 16

Driving Spikes

These driving spikes enable stainless steel earth rods to be driven easily into the ground.

D mm	L mm	Thread Size	L1 mm	Unit Weight kg	Pack Quantity	Part Number
16	42	M10	20	0.03	25	ERCS 16
20	51	M10	20	0.06		ERCS 20
25	60	M12	25	0.10		ERCS 25

Material: Steel.

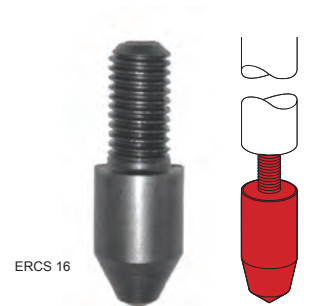
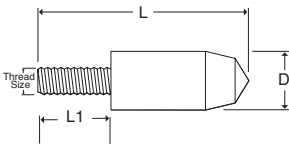

ERCS 16

Coupling Dowels

The stainless steel coupling dowel is used for joining stainless steel earth rods together.

Thread Size	L mm	Unit Weight kg	Pack Quantity	Part Number
M10	40	0.02	25	ERD 16
M12	50	0.04		ERD 25

Material: Stainless Steel.

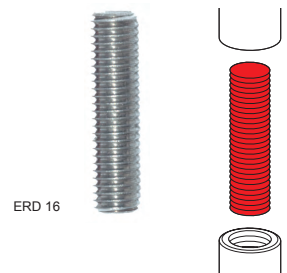
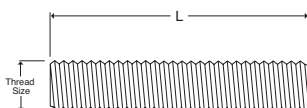

ERD 16